

OWNER'S MANUAL

 **SKYFOLD**[®]
classic[™] series

 **SKYFOLD**[®]
zenith[®] series

 **SKYFOLD**®
classic™ series

 **SKYFOLD**
zenith® series

TRADEMARKS

Skyfold is a registered trademark of Skyfold Inc. and Skyfold Investments Ltd. Other products mentioned in this manual are trademarks or registered trademarks of their respective owners. Skyfold is protected by one or more of the following patents:

- #5,062,464 (USA)
- #6,808,000 (USA)
- #0587572 (EUROPE)
- #653284 (AUSTRALIA)
- #2011226979 (AUSTRALIA)
- #111863236.6 (EUROPE)
- #12108530.6 (HONG KONG)
- #6,267,169 B1 (USA)
- #2,064,348 (CANADA)
- #0587572 (GERMANY)
- #12/893119 (USA)
- #8327905 (USA)
- #2754227 (CANADA)

Other patents pending in various countries.

COPYRIGHTS

All rights reserved. Reproduction of this manual in whole or in part, by any means whatsoever, is prohibited without the prior written consent of Skyfold Inc.



ABOUT YOUR SKYFOLD WALL SYSTEM	4
COMPONENTS	5
OPERATING SWITCHES	5
LIFTING MECHANISMS AND PANELS	6
MOTOR UNITS	9
SKYFOLD WALLS IN OPERATION	12
OPERATING A SKYFOLD WALL	12
BACK-UP OPERATING FEATURE	13
OPERATING TWO SKYFOLD WALLS MEETING AT 90 DEGREES	13
OPERATING MULTIPLE, IN-LINE SKYFOLD WALL SECTIONS OVER STEPPED OR SLOPED FLOORS	14
MAINTENANCE	15
PERIODIC MAINTENANCE	16
ADDITIONAL SERVICING	17
CLEANING	18
WARRANTY	19



Congratulations on your purchase of your Skyfold Wall System, the most technologically advanced and only vertically folding operable wall of its kind.

Before operating your Skyfold wall, please read this manual carefully, as this owner's manual includes a description of the wall's major components, as well as procedures related to the operation of the wall, a maintenance schedule and explanations regarding the warranty.

Your Skyfold wall is a fully automatic, operable wall that is activated by applying pressure to 2 switches simultaneously. In addition to simplicity of operation, please note that your Skyfold wall was designed with safety as a primary concern. This is reflected not only in the design philosophy of the system, but also in certain specific subsystems and components, as follows:

- the wall's movement is stopped instantly when
 - pressure is released from either switch.
 - a loss of power occurs.
 - a mechanical jamming occurs (up direction only).
 - excessive current is being drawn by the motor.
 - pressure is applied on the obstruction sensor along the bottom leading edge of the wall, as this triggers the obstruction sensor and automatically reverses the wall for 3 seconds.

Caution: The sensor will not detect any obstruction that is less than 3" (76mm) from the ends of the Skyfold wall.

- if, at any given time, the downward wall speed is substantially higher than normal, a hydraulic checking device lowers the wall speed.
- the cables used to lift and support your Skyfold wall are of the highest strength and quality. In the unlikely event that a cable fails, this will not affect any of the other cables.
- the programmable logic controller cuts off power if a short circuit is detected on the 12V or 24V line or if polarity is reversed.
- the electrical control box contains the latest in overload protection (models >1HP) and other electrical safeguards.
- the interface between the gearbox and the line shaft also ensures a high degree of safety.
- the movement of the wall is triggered by two switches, thus increasing security.



OPERATING SWITCHES

Figure 1: Key switch

North America

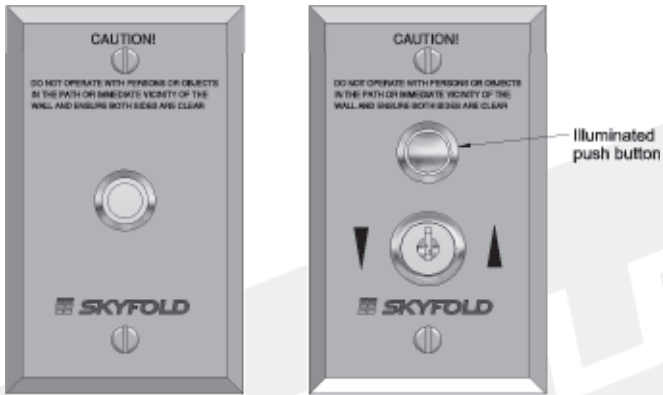

Europe & Asia



In an effort to optimize the safety features provided by the Skyfold wall, two switches are installed at opposite sides of the Skyfold wall. These switches control the wall's movement. Both switches must be activated simultaneously for the wall to move upwards or downwards, while the key is turned to the desired position. This ensures that there are two people present at all times during the operation of the wall.

When one of the switches is released, the wall stops immediately, without coasting.

The keyed switch plate includes an illuminated push button that flashes fault codes if the Skyfold wall does not work when activated. One to ten flashes represent ten different fault codes.

Before operating the switches, please read the safety precautions and the procedures contained in the Skyfold walls in operation section.

LIFTING MECHANISMS AND PANELS

Figure 2: Lifting Mechanisms and Panels

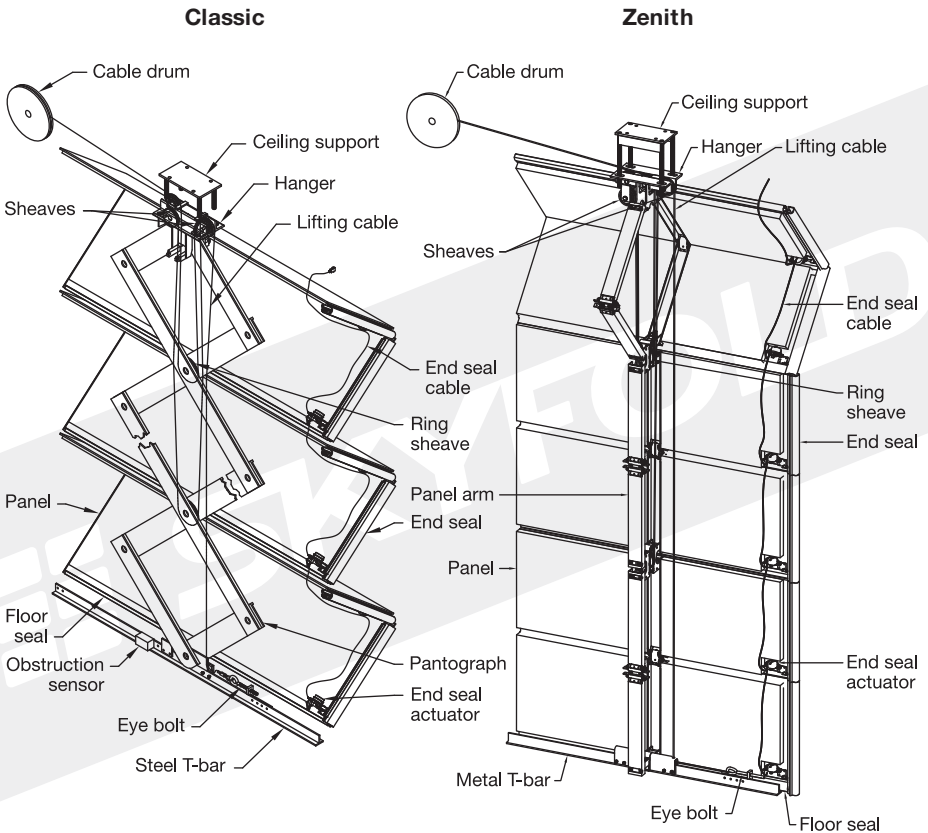

Lifting mechanisms

The internal skeleton of the Skyfold wall consists of a series of lifting mechanisms that are made of structural grade aluminum and steel. For greater longevity and silent operation, all mechanical pivot points are made of high strength steel bolts or pins on plastic bushings. Aircraft-grade wire rope or cables, of the highest strength and quality, pass through the mechanisms and fold and unfold the mechanisms as they wrap and unwrap on their respective drums. See Figure 2.

Panels

The panels are a composite construction with a heavy-gauge steel face sheet to resist abuse. Your choice of finish has been carefully applied to the panels and a thin plastic wrap protects it from dirt and other debris. *See Figure 2.*

The protective coating must be removed at the latest two weeks after the date of shipment. The panels must be stored in a dry, climate-controlled area.

Cables

The cables that lift and support the Skyfold wall are aircraft-grade wire cable of the highest strength and quality. These cables are sized to offer a high factor of safety. Each of these cables is attached to and lifted by a separate drum and each drum is keyed into the solid-steel line shaft. In the unlikely event that a cable fails, this will not affect any of the other cables. *See Figure 2 and Figure 5.*

Sheaves (pulleys)

As illustrated in *Figure 2*, the lifting cables wrap around the sheaves, thus providing an additional pick-up point.

End seals

The flexible end-seal membranes fill the vertical gap between the Skyfold panels and the fixed walls, forming a tight acoustic seal.

The Skyfold wall halts its descent when the lower limit switch stops the lifting motor, and the Skyfold wall then automatically activates the vertical end seals.

It is not necessary to maintain pressure on the switch once this limit switch has been tripped.

The end seals retract automatically when you raise the wall from its fully closed position. The end seals deploy and retract in approximately eight seconds, and as a default setting the wall will not begin to rise until the end seals are completely retracted. Alternatively, at the time of installation the wall can be programmed to start rising once the end seals have cleared the fixed walls. *See Figure 3.*

Figure 3:
Vertical end-seals at fixed wall (shown through Skyfold Classic/Zenith wall)

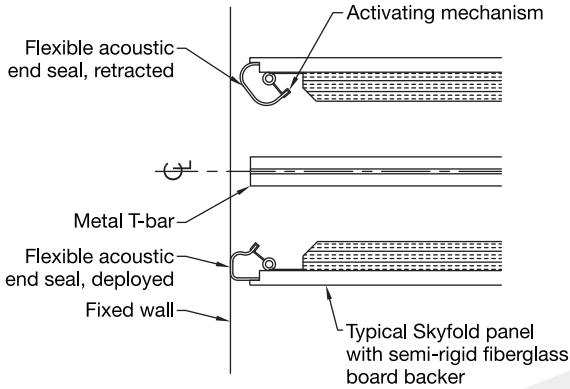
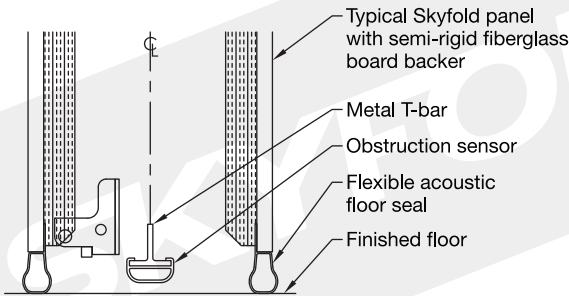

Figure 4:
Obstruction sensor and floor seals (shown through Skyfold Classic/Zenith wall)



Obstruction sensor

The bottom edge of the wall is equipped with an obstruction sensor that runs the entire length of the wall. When the obstruction sensor comes in contact with an obstruction while the wall is descending, power is cut to the lifting motor, the electromagnetic brake engages and the wall’s descent is instantly halted. It then automatically reverses direction for 3 seconds.

Warning



- The sensor will not detect any obstruction that is less than 3” from the ends of the wall.
- After it has reversed direction, ascended for 3 seconds and cleared the obstruction, you must remove the obstruction prior to resuming the Skyfold wall’s descent.
- If the wall has incurred damage, do not operate the wall and call your local authorized Skyfold dealer for an immediate inspection.

Note that the pneumatic sensor is an integral part of the obstruction sensor and is illustrated in *Figure 2 and Figure 4*.

MOTOR UNITS

Figure 5: Standard Drive Unit

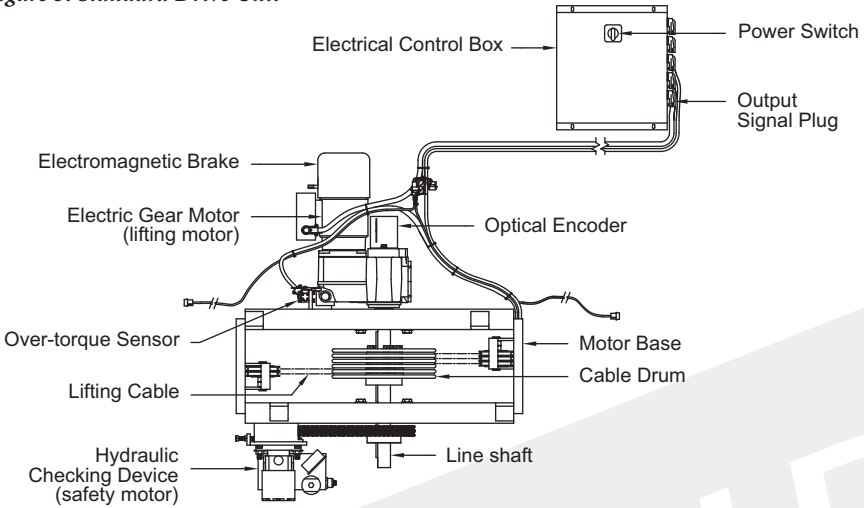

This manual is accompanied by shop drawings that clearly illustrate where the motor unit is located.

Electric gear motor (lifting motor)

Your Skyfold wall system is equipped with a sealed, heavy-duty gear motor that powers the entire system. This lifting motor is designed for hundreds of stops and starts an hour and is rated for service several orders of magnitude more severe than the service it experiences while operating your Skyfold wall.

The lifting motor is equipped with an **electromagnetic brake**. Power to the lifting motor is cut and its electromagnetic brake engages automatically when one of the following occurs:

- A switch is released.
- The wall reaches its upper limit, fully retracted into the pocket.
- The wall reaches its lower limit (fully closed position).
- While descending, the obstruction sensor comes in contact with an obstruction. This triggers the 3 second auto-reverse feature to clear an obstruction.
- While ascending, the over-torque sensor detects excessive torque on the motor.
- The thermal-overload relay in models >1HP, which is located in the electrical control box, detects excessive current being drawn by the motor.
- A short circuit is detected on the 12V or 24V line or if the polarity is reversed
- The main power switch, breaker or fuse is tripped.

Without power, the electromagnetic brake can be manually released by pulling the brake release lever. This allows the wall to descend under its own weight. Its speed is controlled by the hydraulic checking device. The system must be recalibrated before it can be used again. Leave the control box disconnect switch in the off position until it can be calibrated by a certified SKYFOLD installer.

Spring-cushioned torque arm

A spring-cushioned torque arm supports the motor assembly in order to soften the starts and stops of the system. As part of this assembly, there is a sensor on the torque arm that detects higher than normal torque levels. In the event that mechanical jamming has occurred in the system, or if the upper limit switch fails to operate, this over-torque sensor quickly cuts power to the motor. *See Figure 5.*

Line shaft

The line shaft that rotates all of the cable drums is continuous through the gear motor, without a coupling. This assures a higher degree of safety by providing a better interface between the gearbox and the line shaft. *See Figure 5.*

Hydraulic checking device (safety motor)

There is a hydraulic checking device, also referred to as a hydraulic parachute, which is separate from the gear motor assembly and is powered by the line shaft itself. *See Figure 5.*

When the wall is traveling downwards, this hydraulic checking device builds up a certain hydraulic pressure that is dependent on the wall's travel speed. In normal operation, this pressure is very low and this checking device offers no appreciable braking force on the wall. If, at any time, the wall speed is substantially higher than normal, this checking device offers sufficient braking force to lower the wall at a speed of approximately 150% of the normal operating speed.

Electrical control box

Skyfold's electrical control box meets both Underwriters Laboratories (UL) and Canadian Standards Association (CSA) requirements. The enclosure itself is constructed of heavy-gauge steel. It is typically located within 15 feet (4.5 meters) of the motor unit and is accessible via an access panel in the ceiling. For warranty protection, it has a manufacturer's seal, thus deterring unauthorized tampering.

There is a main power switch on the cover of the electrical control box. *See Figure 5.*

In the event that your Skyfold wall does not operate at all, you must ensure that the main power switch is in the "ON" position. Any other type of maintenance or repair work, in these cases, must be performed by your local, authorized Skyfold dealer. Unauthorized work will void the Skyfold warranty, as stated in the Warranty section of this owner's manual. In the case of a system failure or fault the illuminated push button will repeatedly flash one to ten times while being activated. The number of flashes is representative of the fault encountered. This fault code (number of flashes) must be relayed to the Skyfold dealer in order for them to take the necessary action.

Upper (open) and lower (closed) limit control

Your Skyfold wall stops automatically upon reaching its upper limit (fully open) position or its lower limit (fully closed) position. There is no need for the operator to carefully time the release of the switches. These limits are set by the Skyfold installer at the time of installation.

AV / Dry Contact for linked building systems

For integration with other building systems, your Skyfold wall system is equipped with dry contacts identifying when the wall is in the “UP” or “DOWN” position. The dry contacts are sourced from the control box and are labelled as such. See Figure 6.

A maximum power supply of 24 volts is provided by the A/V system that is to be controlled by these contacts. Skyfold provides a connector plug and a 6” (150 mm) long extension cord to the A/V Dry contacts found on the outside of the control box. See Figure 6. The extension cord comes with a male and female connector and a separate female connector is supplied for the connection to the A/V system. The male connector on the extension cord has the following wire designations:

- Black #1 – Wall Down Com1
- White #2 – Wall Down Dry Contact 250mA
- Red #3 – Wall Up Com1
- Green #4 – Wall Up Dry Contact 250mA

Using 18 or 22 gauge wires, the electrician connects the A/V system to the pins in the separate female connector. Access to the interior of the control box is not required for this hook-up and a manufacturer’s seal deters unauthorized entry.

Warning



- > Only qualified Skyfold personnel are authorized to perform any type of maintenance and/or repair work on your Skyfold wall system. Unauthorized work will void the Skyfold warranty, as stated in the Warranty section of this owner’s manual.

Figure 6: A/V Dry Contact Plug (position signal)



A/V Dry Contact Connector Plug

Warning



- > Heat generated by lights inside of the ceiling pocket can cause the Skyfold panels to delaminate. Therefore, you can only turn on lights that are located in the Skyfold ceiling pocket when the wall is completely down and never when the wall is partially or fully retracted into the pocket.



The time required for a Skyfold wall to ascend or descend varies depending on the size of the wall. On average, a Skyfold wall takes approximately two minutes to either completely travel upwards or downwards.

OPERATING A SKYFOLD WALL

The following procedures apply to normal operating situations.

Warning



- Two operators, one per side per switch, are required for the duration of the wall's operation.
- Do not place objects between the panels, underneath the Skyfold wall, or in the near vicinity of the Skyfold wall, as this can cause damage to the Skyfold wall when it is in motion.
- Do not operate your Skyfold wall with persons or objects in the path or immediate vicinity of the Skyfold wall, and ensure that both sides of the Skyfold wall are clear.
- In case of a malfunction, do not operate the Skyfold wall or attempt to repair it. In such a case, call your local, authorized Skyfold dealer for service.
- Do not operate your Skyfold wall if there are any abnormal noises or if the Skyfold wall does not appear to be working properly. In such a case, contact your local, authorized Skyfold dealer immediately.
- Do not operate your Skyfold wall if panels are missing as this can damage the system.
- Heat generated by lights inside of the ceiling pocket can damage the panels. Therefore, you must only turn on lights that are located in the Skyfold ceiling pocket when the wall is completely down and never when the wall is partially or fully retracted into the pocket.
- In cases where an obstruction has caused the Skyfold wall to halt its descent, it will raise automatically (auto-reverse) for 3 seconds to clear the obstruction. You must then remove the obstruction prior to resuming the wall's descent.

1. Ensure that both operators of the Skyfold wall have a clear and unobstructed view of the wall. The Skyfold wall must be monitored from both sides of the wall for the duration of the wall's ascent or descent, as this can prevent injury and/or damage to the Skyfold wall.
2. At both switches, simultaneously, activate and maintain pressure on the switches with the key turned to the desired position.
3. Release the switches when the desired position has been reached or after the wall is stopped automatically by its upper or lower limit controls.

BACK-UP OPERATING PROCEDURE

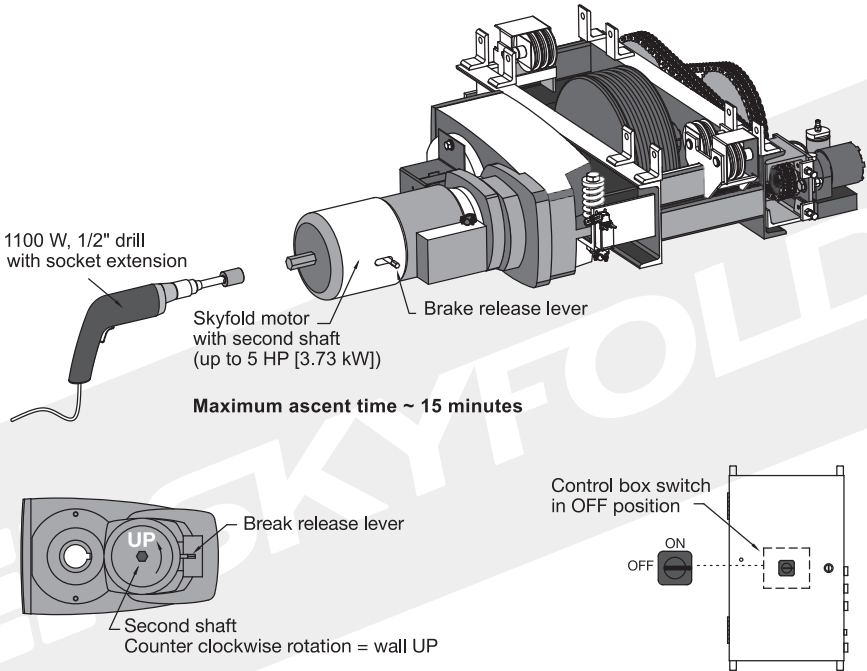

In the unlikely event that the Skyfold wall does not respond to the key switch operation, it could possibly be operated by using a heavy duty drill. A shaft extension through the fan cover of the motor allows for an alternate method of raising and lowering the wall. The system must be recalibrated before it can be used again. Leave the control box disconnect switch in the off position until it can be calibrated by a certified SKYFOLD installer. Please note this diagram is for illustration purposes only.

Please contact your local authorized Skyfold dealer for complete operating instructions

OPERATING TWO SKYFOLD WALLS MEETING AT 90 DEGREES

The following procedures apply to situations where there are two Skyfold walls, and one stacks above the other in the ceiling. In these cases, the wall operating sequence is entirely controlled by the key-switch logic circuit in the electrical control box.

Warning



- Two operators, one per side per switch, are required for the duration of the walls operation.
- Do not place objects between the panels, underneath the Skyfold wall, or in the near vicinity of the Skyfold wall, as this can cause damage to the Skyfold wall when it is in motion.
- Do not operate your Skyfold wall with persons or objects in the path or immediate vicinity of the Skyfold wall, and ensure that both sides of the Skyfold wall are clear.
- In case of a malfunction, do not operate the Skyfold wall or attempt to repair it. In such a case, call your local, authorized Skyfold dealer for service.
- Do not operate your Skyfold wall if there are any abnormal noises or if the wall does not appear to be working properly. In such a case, contact your local, authorized Skyfold dealer immediately.
- Do not operate your Skyfold wall if panels are missing as this can damage the system.
- Heat generated by lights inside of the ceiling pocket can cause the Skyfold panels to delaminate. Therefore, you must only turn on lights that are located in the Skyfold ceiling pocket when the wall is completely down and never when the wall is partially or fully retracted into the pocket.
- In cases where an obstruction has caused the Skyfold wall to halt its descent, it will raise automatically (auto-reverse) for 3 seconds to clear the obstruction. You must then remove the obstruction prior to resuming the wall's descent.

1. Ensure that both operators of the Skyfold wall have a clear and unobstructed view of the wall. The Skyfold wall must be monitored from both sides of the wall for the duration of the wall's ascent or descent, as this can prevent injury or damage to the Skyfold wall.
2. **When closing the Skyfold walls**, ensure that the lower Skyfold wall is in the fully closed position before the upper Skyfold wall can be brought down.
When opening the walls, ensure that the upper Skyfold wall is fully retracted into its ceiling pocket before the lower Skyfold wall can be brought up.
3. At both switches, simultaneously, activate and maintain pressure on the switches with the key turned to the desired position.
4. Release the switches when the desired position has been reached or after the Skyfold wall is stopped automatically by its upper or lower limit controls.

OPERATING MULTIPLE, IN-LINE SKYFOLD WALL SECTIONS OVER STEPPED OR SLOPED FLOORS

Multiple Skyfold wall sections, controlled from a single pair of switches but with their own independent motor units, are used to create a monolithic Skyfold barrier across long distances or over stepped or sloped floors.

There are mechanical acoustic seals between each Skyfold wall section, similar to those found at the ends of the Skyfold wall, which deploy and fill the gap between wall sections. The mechanical seals deploy automatically but only when all wall sections have reached their lower limits.

When raising the Skyfold wall sections from their completely closed positions, there is a default delay of approximately eight seconds while all the mechanical seals retract. Alternatively, at the time of installation the wall can be programmed to start rising once the end seals have cleared the fixed walls.

All Skyfold wall sections operate simultaneously. However, the Skyfold wall sections take different amounts of time to reach their upper and lower limits because of the following factors:

- There can be slight differences in the motor speeds of these wall sections.
- In the case of sloped or stepped floors, there is a difference in height between the upper and lower limits of these Skyfold wall sections.

In these instances, the procedure to operate the Skyfold wall is the same as for normal operating situations. However, the switches must be activated for the entire duration that it takes all sections to reach their respective upper (open) or lower (closed) limits.

MAINTENANCE

Only qualified Skyfold personnel are authorized to perform any type of maintenance and/or repair work on your Skyfold wall.

Warning



- Unauthorized work will void the Skyfold warranty, as stated in the Warranty section of this owner's manual.

However, as the owner of a Skyfold wall, you must assume the basic cleaning responsibilities related to your Skyfold wall.

Periodic servicing and inspection of certain components of the Skyfold wall must be performed to ensure that its mechanical performance, acoustic properties and aesthetics are prolonged and that it operates safely, as originally designed and installed. Contact your local, authorized Skyfold dealer when service is required in accordance with the maintenance schedule outlined below.

A cycle is defined as follows: the Skyfold wall has completed one ascent and one descent.

PERIODIC MAINTENANCE

EVERY 500 CYCLES, OR 1 YEAR

Wall height adjustment (upper and lower limits)

Over time, the lifting cables may stretch and make it necessary to reset the upper (open) position limit and the lower (closed) position limit.

- The upper and lower limits must be verified, inspected and adjusted.

Warning



- The Skyfold wall should stop automatically once it reaches either of these limits. If this is not the case, do not operate the wall and call your local, authorized Skyfold dealer for service.

Lifting cables and rigging hardware

- The lifting cables, drums, bearings, sheaves (pulleys), couplings, tie-offs, and other rigging hardware must be inspected for wear, alignment and fit.

Lifting motor gearbox

- Inspection of the lifting motor gearbox

Electromagnetic brake

- Inspection of the electromagnetic brake

EVERY 500 CYCLES, OR 1 YEAR

Hydraulic checking device (safety motor)

The hydraulic checking device assembly includes a manifold, reservoir, pressure gauge, hydraulic motor, sprocket and chain. During normal operation, the gauge pressure should be 0-100 psi (0-800 kPa) while the wall is ascending and 200-300 psi (15000-2000 kPa) while the wall is descending.

- The hydraulic checking device must be inspected and its operating pressure verified.

1 YEAR AFTER INSTALLATION

Electrical system

- The entire electrical system, including the control box, encoder, over-torque sensor, lifting motor, electromagnetic brake, obstruction sensor, end seals, key switches and all plugs and cables, must be tested.

In the event of complete failure of the electrical system, check the main breaker before calling for service. Note the number of times the illuminated push button flashes when activated and advise your local authorized dealer.

Lifting mechanisms

The lifting mechanisms require little maintenance over their 10,000-cycle life span.

- The lifting mechanisms must be inspected for defects and abnormal wear.

EVERY 500 CYCLES OR 2 YEARS (STARTING ONE YEAR AFTER INSTALLATION)

Hydraulic checking device (safety motor)

- The hydraulic oil must be visually inspected (and changed if required).

PERIODIC MAINTENANCE (cont'd)

EVERY 1000 CYCLES OR 2 YEARS (STARTING ONE YEAR AFTER INSTALLATION)

Electrical system

- The entire electrical system, including the control box, encoder, over-torque sensor, lifting motor, electromagnetic brake, obstruction sensor, end seals, key switches and all plugs and cables, must be tested.

EVERY 1000 CYCLES OR 2 YEARS (STARTING ONE YEAR AFTER INSTALLATION)

In the event of complete failure of the electrical system, check the main breaker before calling for service. Note the number of times the illuminated push button flashes when activated and advise your local authorized dealer.

Lifting mechanisms

The lifting mechanisms require little maintenance over their 10,000-cycle life span.

- The lifting mechanisms must be inspected for defects and abnormal wear.

EVERY 10 YEARS

Lifting motor gearbox

- The gearbox lubricant must be changed.

Hydraulic checking device (safety motor)

- The hydraulic oil must be changed.

ADDITIONAL SERVICING

Over and above the regular maintenance listed above, additional servicing may be necessary, as described in this section.

Visible or audible problems

Ordinarily, your Skyfold wall should operate very smoothly and quietly, possibly with only minor or barely detectable noises from moving parts, lifting cables or motors. When the wall is in the down position, the panels should form a flat vertical surface with approximately 1/2" (13 mm) gaps between panels. When the panels are stored in the pocket, the bottom or floor panels form the bottom of the pocket and should be horizontal and fit neatly and evenly within the pocket (within manufacturer's tolerances).

Flashing illuminated push button

If the illuminated push button flashes repeatedly one to ten times while attempting to operate the Skyfold wall then a fault has been detected. Contact your local authorized Skyfold dealer for service.

Warning



- Do not operate your Skyfold wall if there are any abnormal noises or if it does not appear to be working properly. In such a case, contact your local, authorized Skyfold dealer immediately.

Lifting cables and rigging hardware

Lubrication of the chains must be done according to the use of the Skyfold wall, and the environment where they are located. It is suggested to have the condition of the chains inspected and to verify chain tension during each routine servicing visit.

Lifting motor and electromagnetic brake

The electromagnetic brake halts the Skyfold wall's movement at the instant that power is cut to the motor. If this is not the case, the electromagnetic brake may require adjustment.

Hydraulic checking device (safety motor)

Lubrication of the chain and sprocket must be done according to the use of the Skyfold wall, and the environment where it is located. It is suggested to have the condition of the chains inspected during each routine servicing visit.

CLEANING

As the owner of a Skyfold wall, you are responsible for cleaning certain parts of your Skyfold wall.

Flexible perimeter seals

The Skyfold wall can lose some of its acoustic properties if a seal does not activate or if a gap is still present after the seals have been activated. Conversely, an unretracted seal, dragging on the fixed wall, can cause damage to the finish on the fixed wall or can cause damage to the seal. *See Figure 2 to Figure 4.*

Warning



- Do not operate your Skyfold wall if some or all of the vertical end seals do not retract. If either condition occurs, contact your local, authorized Skyfold dealer for service.

Dust build up on the rubber seals can be transferred to the fixed walls and floor. The seals can be cleaned, if required, using a damp cloth.

Panel cleaning

Dust may collect on the panels when they are stored in the ceiling pocket. The panels can be vacuumed with a brush attachment or by other non-abrasive means.

Warning



- Do not use harsh solvents or cleaners and consult the finish fabricator's cleaning specifications before attempting to clean the finish. If damaged, individual panels can be replaced, or removed and repaired, as required (in such cases, contact your local, authorized Skyfold dealer for service.)
- Do not operate your Skyfold wall if panels are missing as this can damage the system.

Skyfold Basic Warranty: The operable wall shall be warranted free from defects in material and workmanship for a period of two (2) years or five thousand (5,000) cycles, whichever occurs first.

Extended Parts Warranty (optional): An extended warranty on parts is available in addition to the basic warranty. It includes coverage on all parts for a period of ten (10) years or five thousand (5,000) cycles, whichever occurs first.

Replacement parts are warranted for a period of one (1) year from date of shipment or the balance of the original warranty period, whichever is longer.

Furthermore, the **Skyfold** warranty includes the following additional guarantees:

- the acoustical performance of the Skyfold wall will be unaffected for a period of (10) ten years or 5,000 cycles, whichever occurs first.

In all the cases stated above, the period covered by the warranty begins on the date of shipment.

THIS WARRANTY DOES NOT COVER THE FOLLOWING:

- Parts and labour required to maintain the operable wall and all parts subject to normal wear and tear are specifically excluded from warranty coverage.
- Damages incurred from improper use or mistreatment;
- Excessive force beyond the normal daily operation of the product;
- Negligence;
- Acts of God.

Skyfold Inc. will carry out any repairs required to the Skyfold wall due to defects in materials or workmanship and occurring under normal use, at no charge for parts and/or labor during the warranty period, provided that:

- the Skyfold wall was operated according to manufacturer's specifications and/or operating instructions;
- the Skyfold wall was always operated by two people, one per side of wall, each activating a switch wired in series with the other.
- all servicing and inspections have been performed by a local, authorized Skyfold dealer, according to the maintenance schedule included in this manual;
- the Skyfold wall was operated in a normal environment similar to the one that prevailed when it was originally installed.

Maximum liability of Skyfold Inc. is limited to the initial purchase price of the product providing that required maintenance and servicing have been done. By no means shall **Skyfold Inc.** be liable for any consequential, indirect, incidental or special damages arising from the sale or use of the product, whether by contract or otherwise.

This warranty supersedes all other warranties, whether oral, written or implied. Should the need arise to modify this warranty to meet special circumstances, it must be amended in writing, witnessed and signed in the presence of the **Skyfold Inc.** administration.